



Cunniff Elementary School
Site - 106,000 sq. ft.
Building - 34,150 sq. ft.
MSBA - 56,150 sq. ft.
2016 - 315 students
2021 - 286 students
2026 - 281 students



Lowell Elementary School
Site - 151,100 sq. ft.
Building - 81,720 sq. ft.
MSBA - 69,130 sq. ft.
2016 - 415 students
2021 - 410 students
2026 - 404 students



Hosmer Elementary School
Site - 346,700 sq. ft.
Building - 124,240 sq. ft.
MSBA - 97,870 sq. ft.
2016 - 561 students
2021 - 669 students
2026 - 675 students

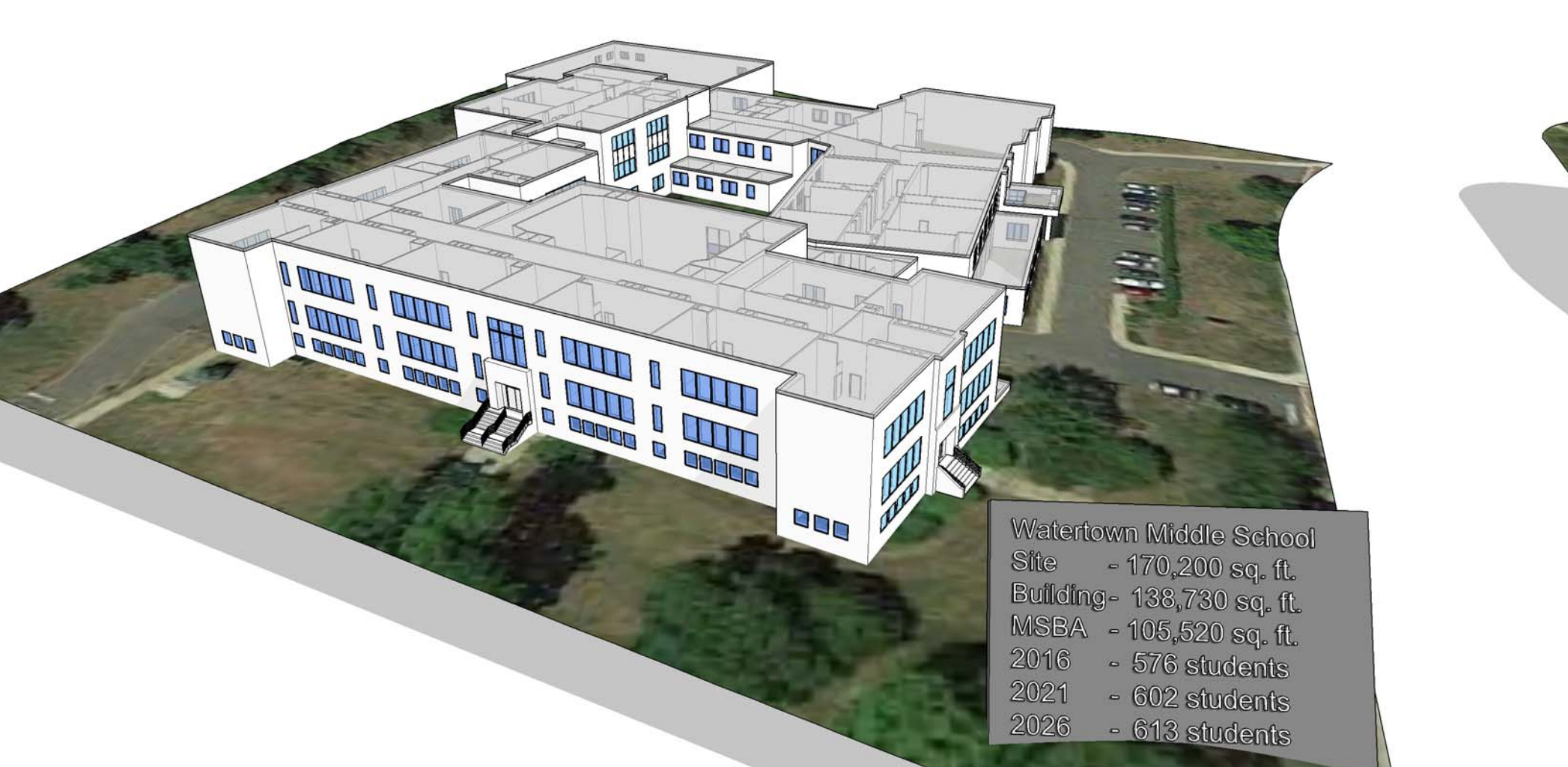

Watertown Middle School
Site - 170,200 sq. ft.
Building- 138,730 sq. ft.
MSBA - 105,520 sq. ft.
2016 - 576 students
2021 - 602 students
2026 - 613 students



Watertown High School
Site - 178,500 sq. ft.
Building - 192,270 sq. ft.
MSBA - 161,140 sq. ft.
2016 - 686 students
2021 - 715 students
2026 - 771 students



Administration Building
Building - 31,520 sq. ft.